

## MASTER EXHIBITS

Create a new master exhibit file using the seed file RWEXH.dgn.

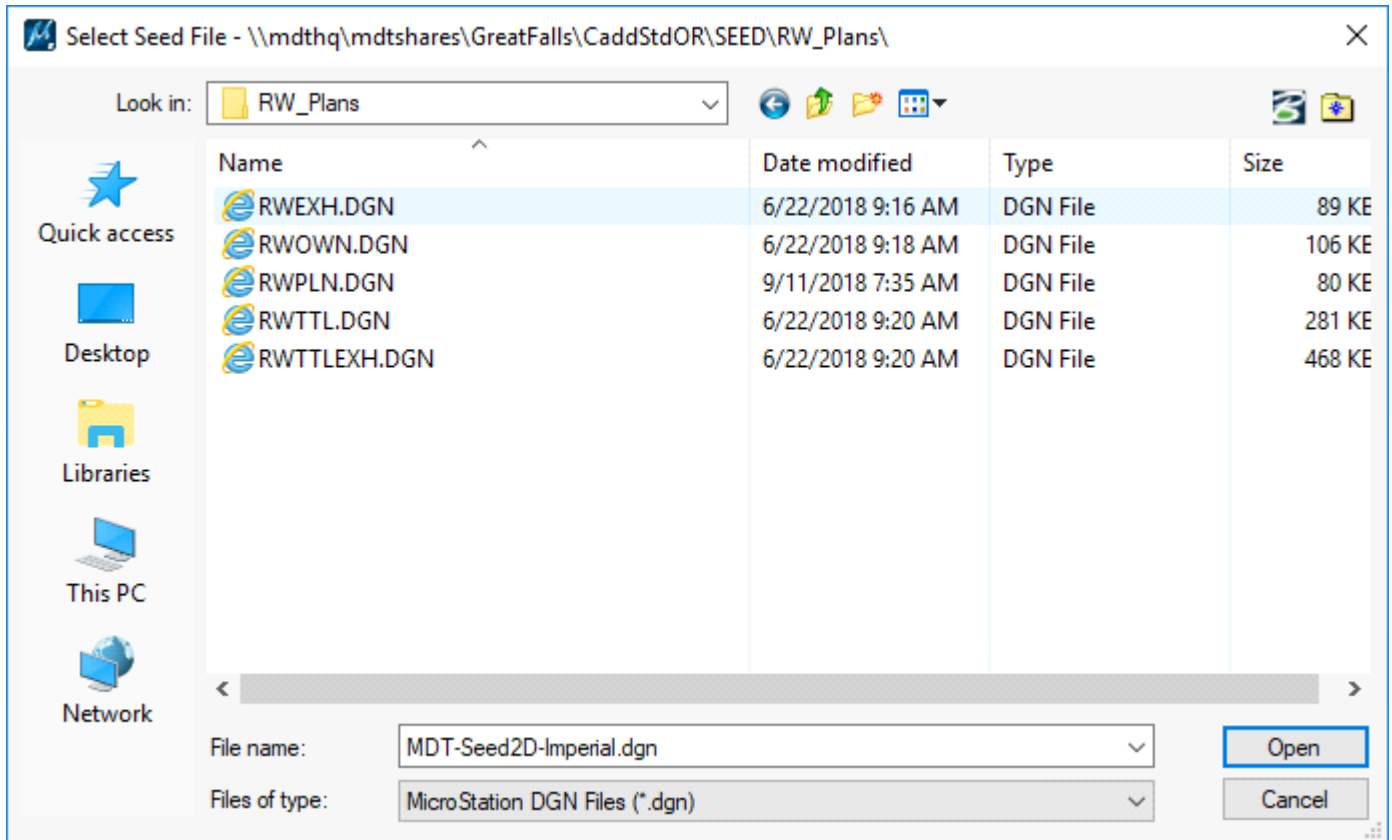

Save as XXXXXXROEXH001.dgn.

Within the master exhibit file open the Reference dialog box, select Tools\Attach and attach the ROPLN file using an Orientation of Coincident - World and set Nested Attachments to Copy Attachments.

Reference Attachment Settings for 8866000ROPLN001.DGN

File Name: 8866000ROPLN001.DGN  
 Full Path: C:\dgn\8866000ROPLN001.DGN  
 Model: Default  
 Logical Name: ROPLN-1  
 Description: Global Origin aligned with Master File

Orientation:

View	Description
Coincident	Aligned with Master File
Coincident - World	Global Origin aligned with Master File
Geographic - AEC Transform	Calculated Transform, max error 7.95...
Geographic - Reprojected	Reproject reference data to Master GCS
Standard Views	
Saved Views (none)	
Named Fences (none)	

Detail Scale: 6" = 1'-0"  
 Scale (Master:Ref): 1.000000 : 1.000000

Named Group:   
 Revision: No Nesting  
 Level: Live Nesting  
 Nested Attachments: Copy Attachments Nesting Depth: 1  
 Display Overrides: Allow  
 New Level Display: Use MS\_REF\_NEWLEVELD\*  
 Global LineStyle Scale: Master  
 Synchronize View: Volume Only

Toggles

Drawing Title  Create  
 Name: Drawing

OK Cancel

Within the Reference dialog box include a correct Logical Name and Logical Prefix for all reference files. Detach REF1 and RDPLP references files.

Attach the ROARE file by selecting the ROMAP reference file and choosing Tools\Copy. Select a point to copy from and the same point to copy to. Double click the copied file to edit the File Name and Logical Name to the ROARE file.

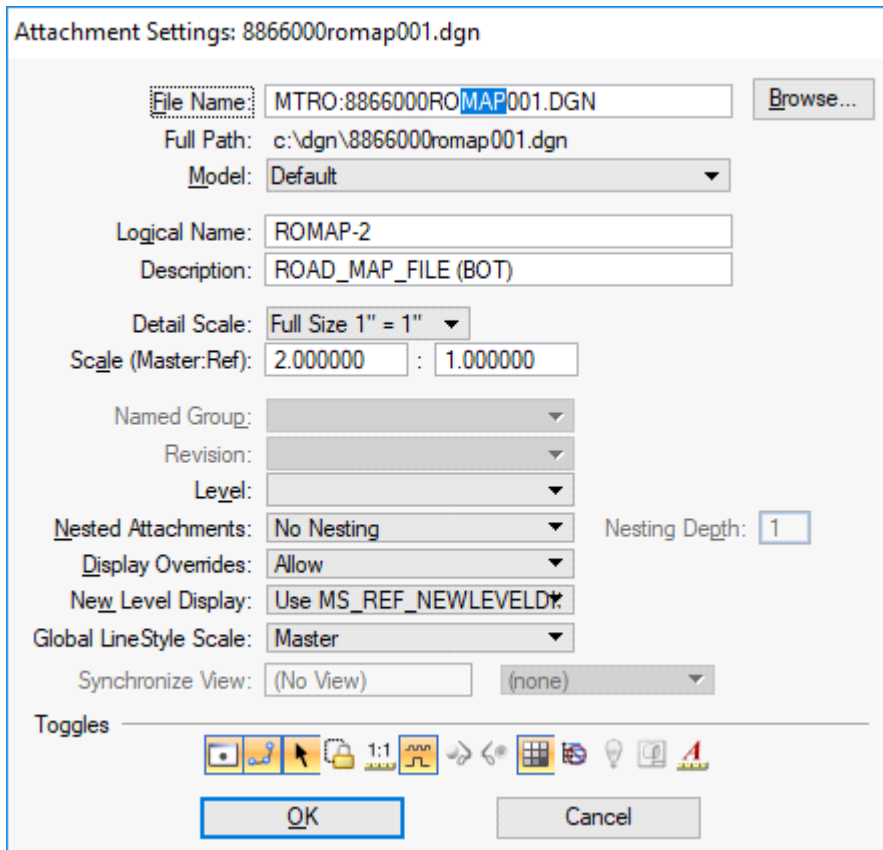

In the Reference dialog box select Settings\Update Sequence. Select the area file(s), move it to the top of the sequence and select OK.

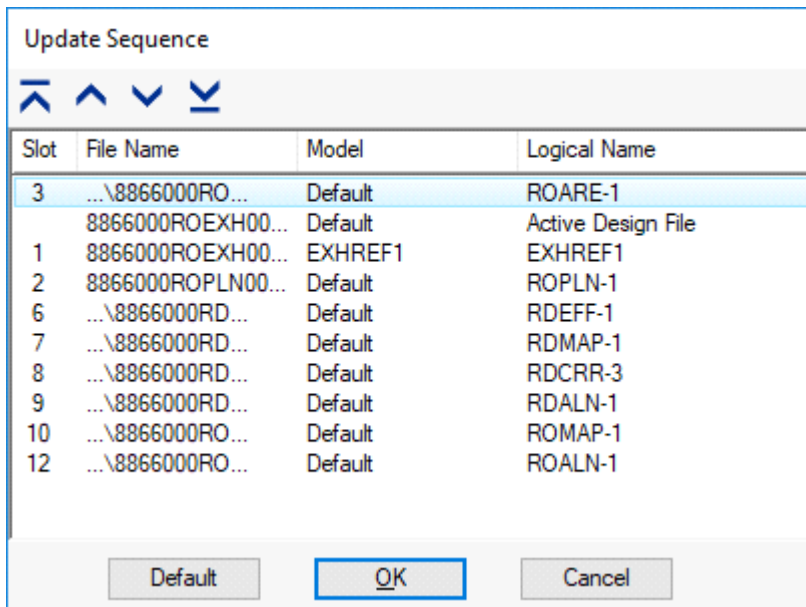

Within the Level Display dialog, set the level filter to RW EXHOFF, select all files, right click on the levels and choose All Off.

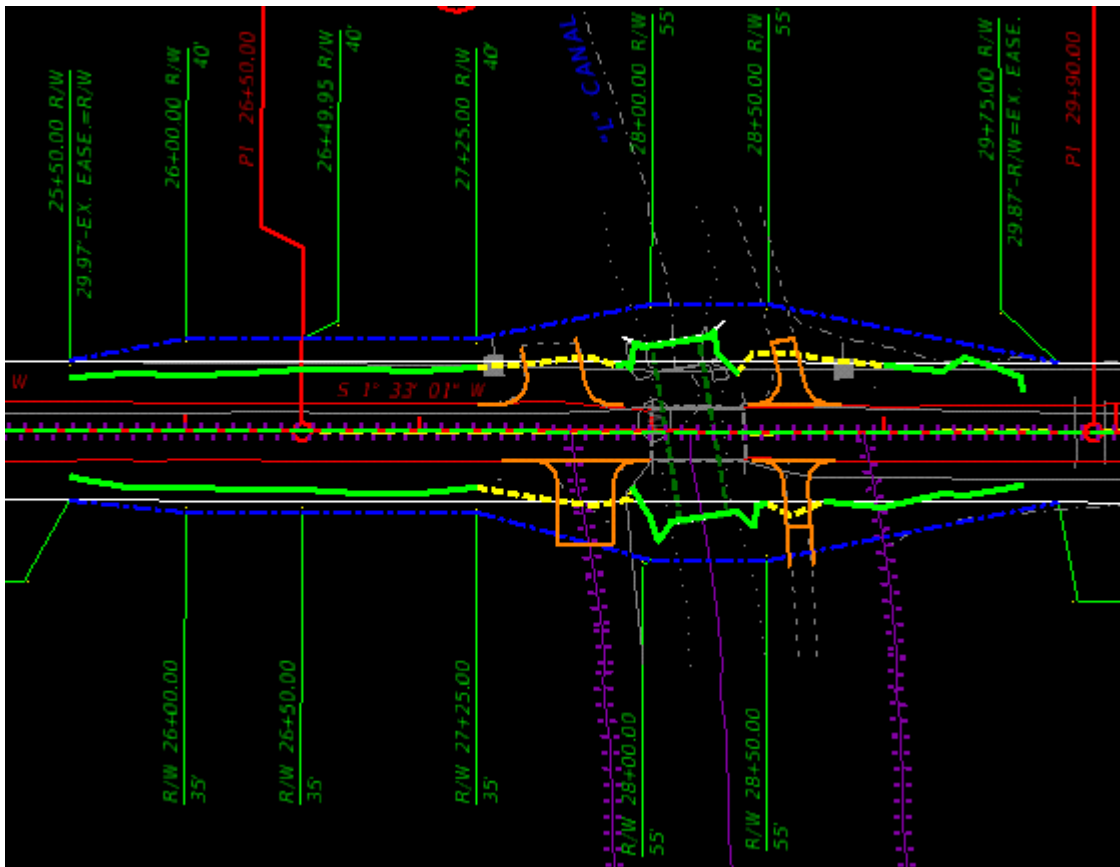

Some levels may still need to be turned off by element.

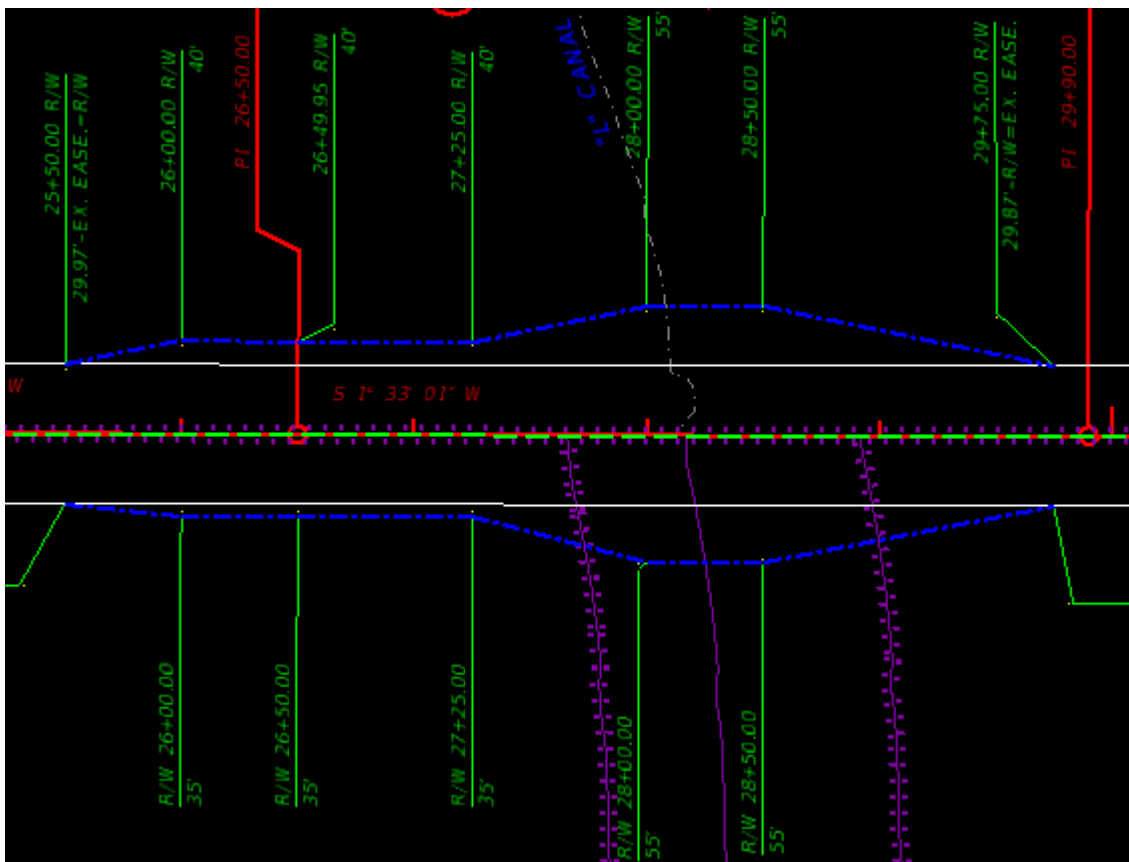

Section 25-1.1 of the Right of Way Design Manual contains a list of information from the plans that should be shown on the exhibits.